

## Model 1889/1911 Diagram

### Militärrepetierer Schweizer Karabiner Modell 1889 und 1911

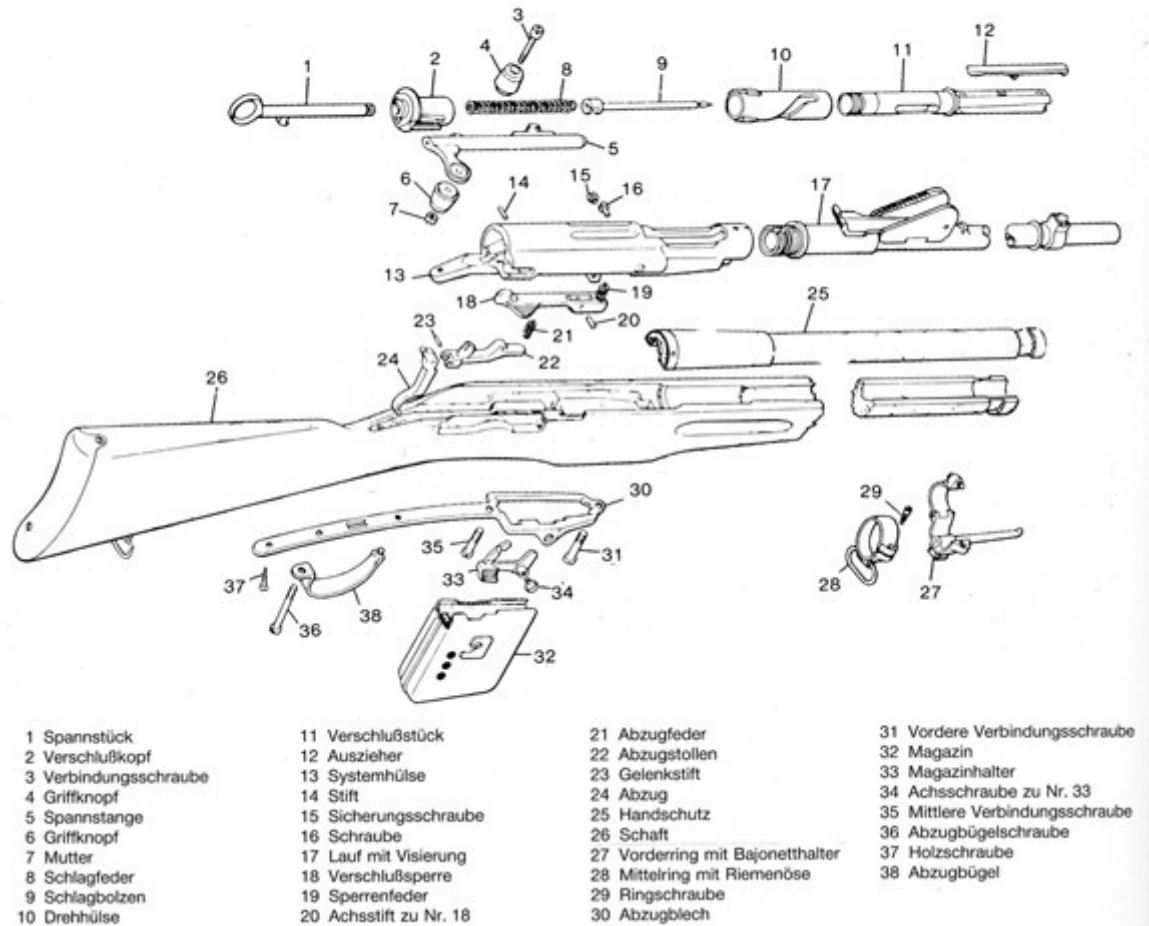

1. Cocking Piece	20. Bolt Stop Pin
2. Bolt Plug	21. Trigger Spring
3. Bolt Knob Screw	22. Sear Arms
4. Upper Bolt Knob	23. Trigger Pin
5. Bolt Cam Follower Rod	24. Trigger
6. Lower Bolt Knob	25. Upper Handguard
7. Knob Nut	26. Stock
8. Firing Pin Spring	27. Front Band
9. Firing Pin	28. Rear Band
10. Bolt Locking Sleeve	29. Band Screw
11. Bolt	30. Trigger and Magazine Plate
12. Extractor	31. Front Plate Screw
13. Receiver	32. Magazine
14. Sear Hinge Pin	33. Magazine Cut-Off (1889 only)

15. Ejector Lock Screws	34. Magazine Cut-Off Screw (1889 only)
16. Ejector	35. Middle Plate Screw
17. Barrel	36. Rear Plate Screw
18. Bolt Stop	37. Trigger Plate Screw
19. Bolt Stop Spring	38. Trigger Guard